



301 N. Hillcrest
Sulphur Springs, TX 75482

2000 I-30 E
Greenville, TX 75402

108 W. Marble
Wylie, TX 75098

Tuesday, September 1, 2020

Office of Hopkins County Judge
PO Box 288
Sulphur Springs TX 75483

Farmers Electric Cooperative Member: REGINA LOPEZ
Service Order Number: 2020083935

Greetings:

Farmers Electric Cooperative, Inc. is requesting permission to construct electrical power distribution facilities which will cross County Road 1127 which is located 1500 FT N OF CR 1152 in Hopkins County, Texas.

Site location map and construction sketches are enclosed. The construction sketch details the proposed work. All road crossings will have a minimum vertical clearance of 22 feet.

If you have any questions, please contact me at any time.

Sincerely,

Meagan Lee
Project Coordinator
meaganl@farmerselectric.coop
Phone 903-513-0378

Submitted by Psalm Harper
pharper@farmerselectric.coop
Field Engineering Coordinator

Enclosures

County Approval Section:

Approved: Denied:
Authorized Signature: *Psalm Harper* Date: 9/24/20

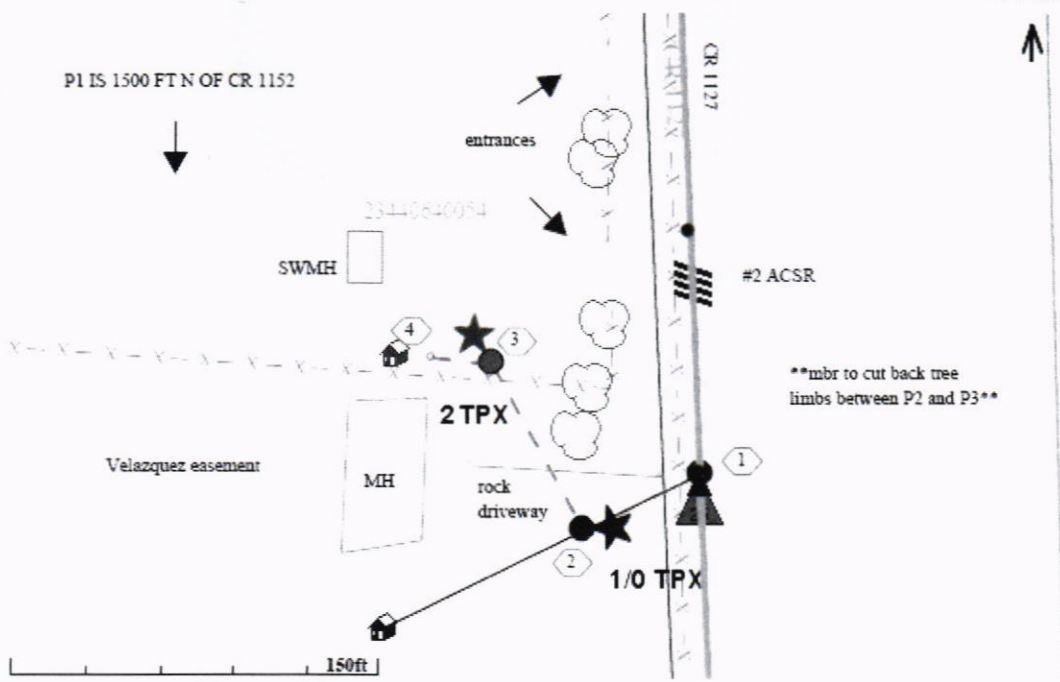

23440640054

CROSSING CR 1127 AT POLE 121181 WHICH IS 1500 FT N OF
CR 1152

NORTH CENTRAL SERVICE AREA
DON PHILLIPS

054858

County Road 1127 S

7

NORTH CENTRAL SERVICE AREA

121182

